

Independence™

Sealed Rechargeable Lead-Acid Battery



NP7-12
NP7-12FR
12V, 7.0Ah

Specifications

Nominal Voltage 12V
Nominal Capacity
 20 hr. rate of 0.35A to 10.50 V. . . . 7.0Ah
 10 hr. rate of 0.65A to 10.50 V. . . . 6.5Ah
 5 hr. rate of 1.19A to 10.20 V. . . . 5.95Ah
 1 hr. rate of 4.20A to 9.60 V 4.2Ah

Weight (approx.) 6.17 lbs
 (2.64 kgs)

Energy density (20 hr. rate)
 1.49 WH/cubic inch
 (91.0 WH/litre)

Specific energy (20 hr. rate)
 13.6 WH/pound
 (30.0 WH/kg)

Internal resistance of charged battery
 30 milliohms (approx.)

Maximum discharge current with standard terminals 40 amperes

Maximum short-duration discharge current
 210 amperes

Operating temperature range
Charge 5°F to 122°F
 (-15°C to 50°C)
Discharge -4°F to 140°F
 (-20°C to 60°C)

Charge retention (shelf life) at 68°F (20°C)
1 month 97%
3 months 91%
6 months 85%

Life expectancy
Standby use 3 to 5 years

Cycle use (approx.)
100% depth of discharge 250 cycles
50% depth of discharge 550 cycles
30% depth of discharge 1200 cycles

Sealed construction
 Can be operated or stored in any position without leakage.

Standard terminal Quick Disconnect .187 or Optional .250

Housing material ABS Resin or ABS Flame Retardant (UL94-V0)

Dimensions

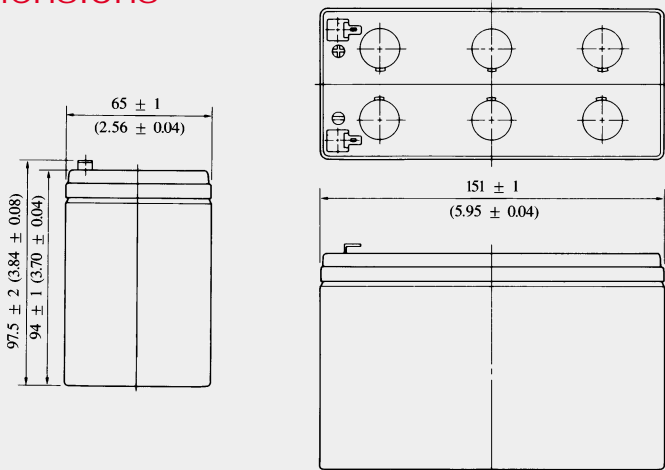

DIMENSIONS: MM (INCHES)

Terminal

Available with .250 option

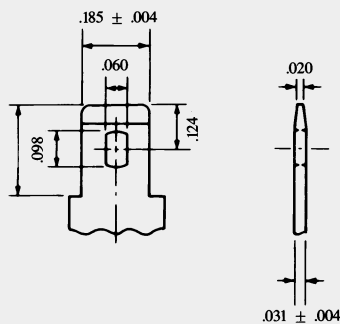

DIMENSIONS: (INCHES)

INCH = MM	
.250	6.35
.185	4.70
.124	3.15
.098	2.49
.060	1.52
.031	0.79
.020	0.51
.004	0.10

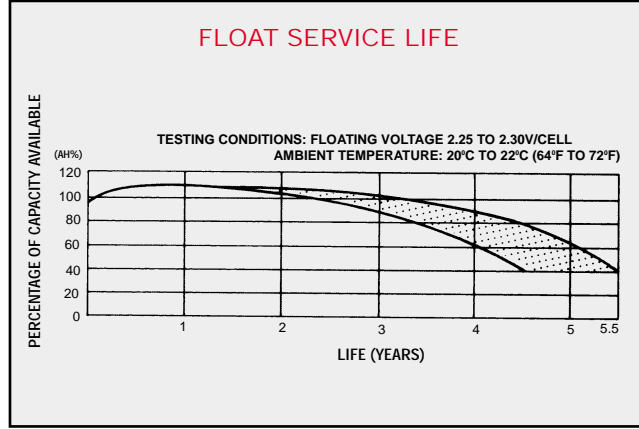
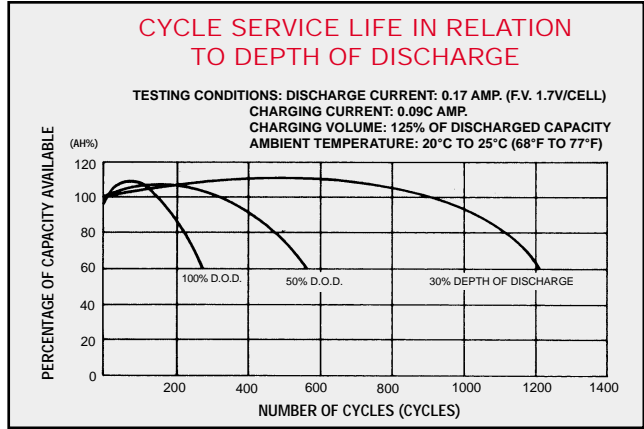
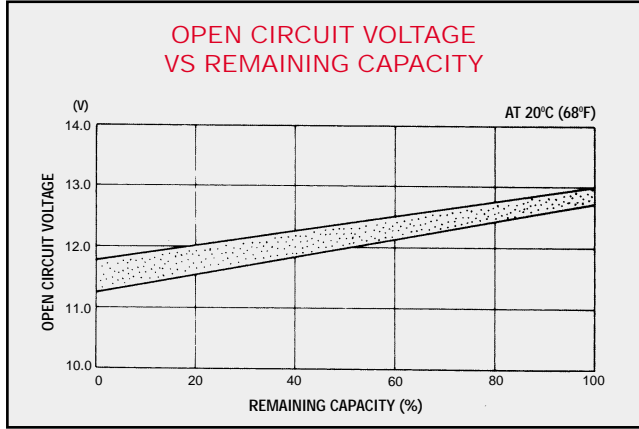
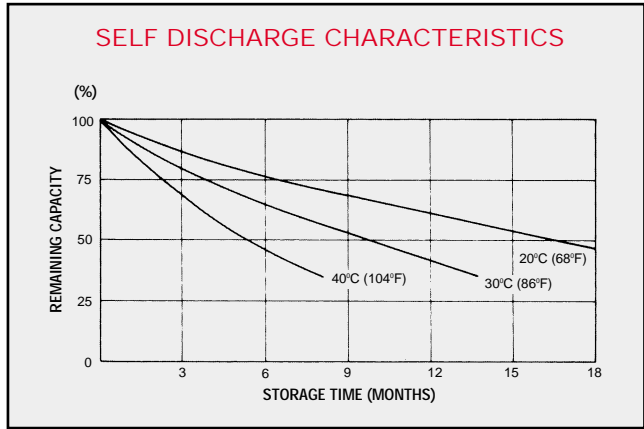
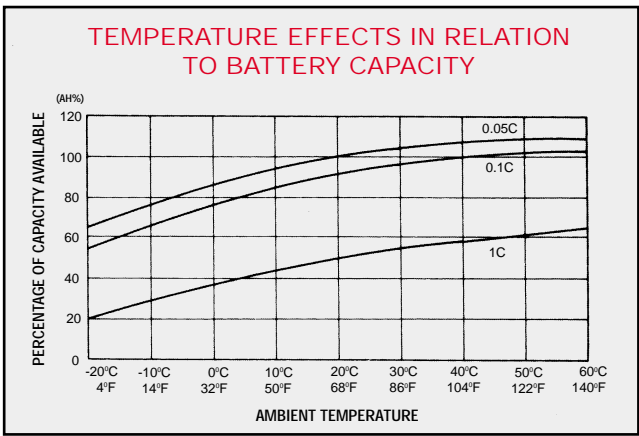
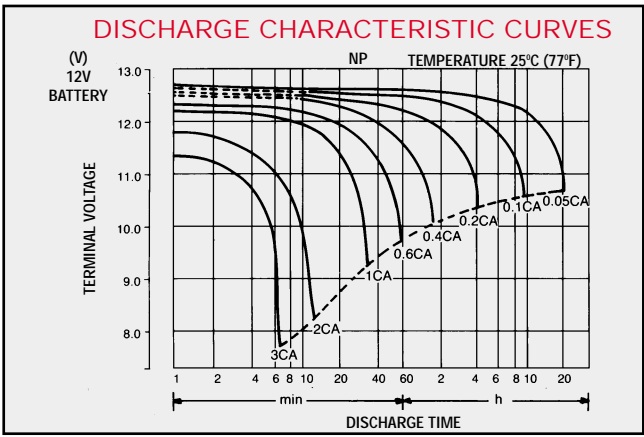

When the battery will be used by the current in excess of 3C, consult with Yuasa, Inc. prior to use.

CHARGING METHODS (AT 20°C) Cycle use: Maximum charging current 1.75A
 Charging voltage 14.4 to 15.0V
 Standby use: Float charging voltage 13.50 to 13.80V

- CAUTION**
- Avoid short circuit
 - Do not charge in a sealed container.

Distributed by:



When ordering new batteries, also remember to properly recycle your old lead batteries. Most federal and state regulations require lead-acid batteries be recycled. Yuasa, Inc.'s nationwide service organization can arrange pickup, transportation to and recycling at any one of our company affiliated smelters. Call 1-800-972-7372 for more information.



Sales Offices
 Eastern Region: 201-641-5900 • 1-800-962-1287
 FAX 201-641-8720
 Western Region: 562-949-4266 • 1-800-423-4667
 FAX 562-949-5527
 Corporate Office: P.O. Box 14145, Reading, PA 19612-4145
 FAX 610-372-8613
 Visit us on the web at: www.yuasainc.com